



Ground Penetrating Radar Suveys

GPR wall thickness surveys

GPR offers an NDT method of determining party wall thickness with access to one side only.

Physical measurement of wall thickness can often be very difficult if not impossible, particularly if access is only available to one side. Party walls are a good example of this.

GPR offers an NDT survey method of determining the thickness of concrete and solid masonry walls. It can also be used to determine the location of any wall protrusions, columns and chimney breasts on the other side of the wall. Results can be marked onto CAD drawings or annotated on radargrams showing a pseudo section view of the surveyed wall.

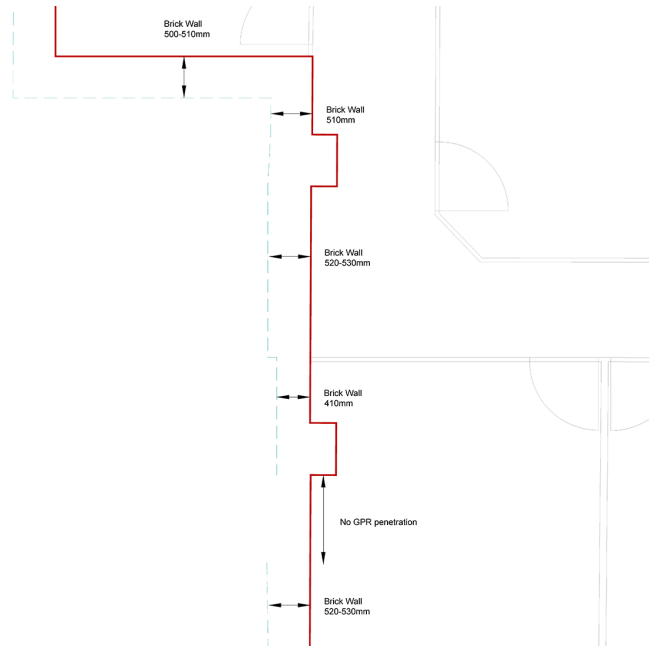

Scanning a wall to determine thickness. Antennas with different central frequencies can be used to provide different penetration depths.

- Can be used for brick, masonry and concrete walls
- Works through plaster and render finishes
- Can be undertaken in occupied buildings
- Minimum disruption to the occupants
- No need to remove most decorative finishes
- No noise or dangerous emissions